

ITEM#	DESCRIPTION	MATERIAL	PART NO./MATERIAL	QTY.
133	CASING	POLYPRO/PVDF	133P400167-576/383	1
660	DRAIN PLUG	POLYPRO/PVDF	660P102497-576/383	1
590A	O-RING	VITON/EPDM	590P2110-830/216	1
850	SHAFT	CERAMIC	850P101933-150	1
183	1035NT CUTWATER	POLYPRO/PVDF	183P201327-576/383	1
183	1040NT CUTWATER	POLYPRO/PVDF	183P201326-576/383	1
990	THRUST WASHER	CERAMIC	990P102222-150	1
990A	THRUST WASHER	CERAMIC	990P101934-150	1
080	IMPELLER BEARING	CARBON/SIL-CAR	080P102529-100/755	1
080A	MAGNET BEARING	SIL-CAR	080P1021221-755	1
080A	MAGNET BEARING	CARBON	080P102025-100	1
590	O-RING	VITON	590P102512-830	1
790D	O-RING	EPDM	790P2256-216	1
430	IMPELLER	POLYPRO/PVDF	SEE TABLE	1
562	DRIVEN MAGNET	POLYPRO/PVDF	SEE TABLE	1
180	CUP	PVDF	180P301061-383	1
250	DISC	SS	250P202086-685	1
561	DRIVE MAGNET STD.	VARIES	561P201308-520	1
561	DRIVE MAGNET HG.	VARIES	561P201956-520	1
800	SET SCREW	STEEL	800P022004-720	2
010	ADAPTER	NORYL	010P400169-513	1
574/575	MOTOR	VARIES	SEE TABLE	1
790	BOLT	SS	790P5168104-680	4
790A	BOLT	SS	790P5168204-680	4
790B	BOLT	SS	790P031606-680	5
790C	BOLT	SS	790P5161806-680	1
990B	WASHER	SS	990P516-680	20
610	HEX NUT	SS	610P51618-670	9
040	BASEPLATE	FRP/SS	040P202225-240	1
040	BASEPLATE	FRP/SS	040P20226-240	1
990C	WASHER	SS	990P0307-680	4
590B	O-RING	VITON/EPDM	590P2244-830/216	2
590C	O-RING	VITON/EPDM	590P2230-830/216	2
140	CHAMBER COVER	POLYPRO/PVDF	140P301062-576/383	2
130	CLAMP RING W/KNOB	SS	130P1019941-680	1
031	BASKET	POLYPRO/PVDF	031P301075-575/384	1
391	HANDLE	POLYPRO/PVDF	391P201350-576/384	1
662	PRIMING CHAMBER	POLYPRO/PVDF	662P400168-576/383	2
770	SPACER	POLYPRO/PVDF	770P102024-576/383	1
440	INSERT	BRASS	440P101995-080	1
130A	CLAMP RING SMALL	SS/303/304	130P101993-680	2
130B	CLAMP RING LARGE	SS/303/304	130P101994-680	1
033	BAFFLE	POLYPRO	033P301063-576	1

IMPELLER

MATERIAL	MODEL	CARBON/SIL-CAR
POLYPRO	1035N	430P202211-579/573
	1040N	430P202210-579/573
	1040W	430P202209-579/573
PVDF	1035N	430P202211-381/386
	1040N	430P202210-381/386
	1040W	430P202209-381/386

DRIVEN MAGNET

MODEL	MATERIAL
STANDARD POLY	562P102598-579/573
STANDARD PVDF	562P102598-381/386
HG POLY	562P102599-579/573
HG PVDF	562P102599-381/386

TEFC MOTORS

HP	115/208-230 VOLTS 50/60 HZ 1 PHASE	208-230/308-460 VOLTS 50/60 HZ 3 PHASE
1/2*	575P00M32313D40	574P00M35333D40
3/4*	575P00N32313D40	574P00N35333D40
1*	575P01032313D40	574P01035333D40
2**	574P02032313D40***	574P02036333D40
3**	-----	574P03036333D40

* - FOR 230V SINGLE PHASE WIRED MOTORS CHANGE FIRST 3 DIGITS FROM 575 TO 576.
 ** - APPLIES TO HG MAGNETS ONLY.
 *** - 115/230 VOLT

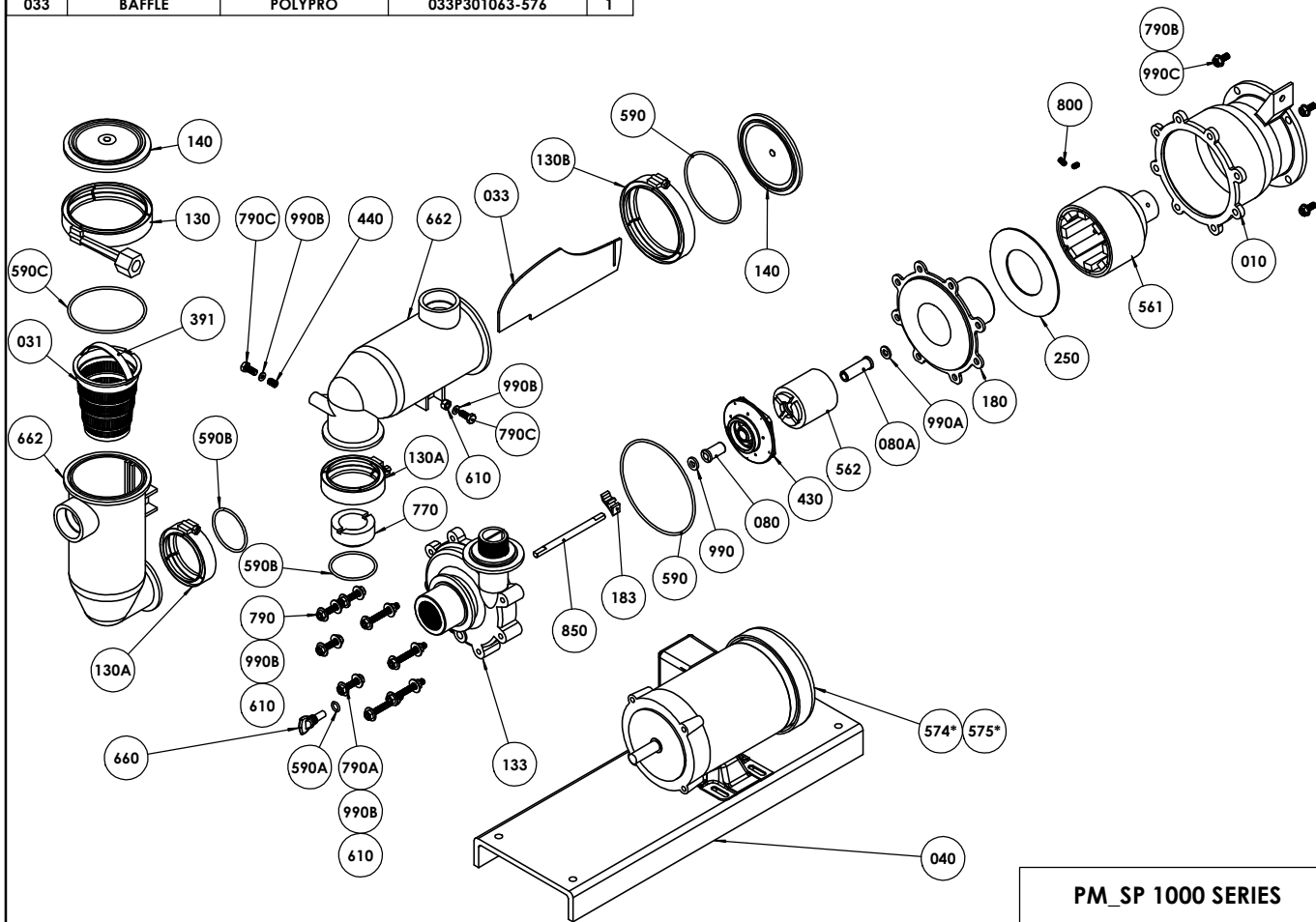

PM_SP 1000 SERIES